

Gefen

®

HDMI Switcher

USER MANUAL

EXT-HDMI-241N



www.gefen.com

ASKING FOR ASSISTANCE

Technical Support:

Telephone (818) 772-9100
(800) 545-6900

Fax (818) 772-9120

Technical Support Hours:

8:00 AM to 5:00 PM Monday through Friday PST

Write To:

Gefen, LLC
C/O Customer Service
20600 Nordhoff St.
Chatsworth, CA 91311

www.gefen.com
support@gefen.com

Notice

Gefen, LLC reserves the right to make changes in the hardware, packaging and any accompanying documentation without prior written notice.

HDMI Switcher is a trademark of Gefen, LLC

© 2010 Gefen, LLC, All Rights Reserved
All trademarks are the property of their respective owners.

TABLE OF CONTENTS

- 1 Introduction
- 2 Features
- 3 Panel Descriptions
- 4 Connecting and Operating the HDMI Switcher
- 5 RMT2-IR Installation
- 6 IR Conflict Codes
- 7 IR Extender Installation
- 8 Specifications
- 9 Warranty

INTRODUCTION

Congratulations on your purchase of the Gefen HDMI Switcher. Your complete satisfaction is very important to us.

About Gefen

Gefen's line of HDMI switches, extenders, and splitters are designed to make your A/V equipment use more comfortable, more productive and less expensive.

The HDMI Switcher allow access to multiple HDMI devices, using a single HDMI display while the HDTV extender product line can extend HD video signal up to 1640 feet (500 meters).

Gefen products offer solutions for noise, space and security concerns, data center control, information distribution, conference room presentation, school and corporate training environments.

Our Commitment

Gefen will always offer the finest quality product at the best possible price. Included in that price is a lifetime of support from a team of outstanding engineers.

The Gefen HDMI Switcher allows two HDMI devices to be switched easily in to one HDMI compatible monitor or projector. The HDMI Switcher can also be placed at the end of a long HDMI cable to regenerate the HDMI signal.

FEATURES

Features

- Switches easily between any two HDMI sources
- Maintains 480i, 480p, 720p, 720i, and 1080i, 1080p resolutions
- Extends any HDMI compliant device by regenerating the HDMI signal
- Maintains high resolution video—beautiful, sharp HDTV resolutions up to 1080P are easily achieved. For computer users, the 2x1 HDMI Switcher conforms with HDMI specifications for resolutions up to 1920 x 1200.
- Supports DDWG standard for HDMI compliant monitors
- Supports HDCP compliant devices
- Optional RMT-2 remote control
- Installs in seconds

Includes:

- (1) HDMI Switcher
- (2) 6' HDMI cables (M-M)
- (1) 5V DC Power Supply
- (1) RMT2-IR
- (1) Manual

PANEL DESCRIPTIONS



Connects to IR extender

IR eye

Indicates if port 1 or port 2 is selected

Selects port 1 or port 2



Connects to 5VDC power supply

HDMI In 1

HDMI In 2

HDMI Out

CONNECTING AND OPERATING THE HDMI SWITCHER

How to Connect the HDMI Switcher to your devices

- 1 Connect the supplied HDMI to HDMI cables from the HDMI sources into the HDMI Switcher Input.
- 2 Connect the cable from your display (monitor or projector) into the HDMI Out of the HDMI Switcher.
- 3 Plug the 5VDC power supply into the HDMI Switcher.

How to Operate the HDMI Switcher

- 1 Use the front panel push button to switch between sources.
- 2 Alternatively, use the RMT2-IR remote control port to remotely toggle between sources.

Connection diagram for the 2x1 HDMI Switcher:

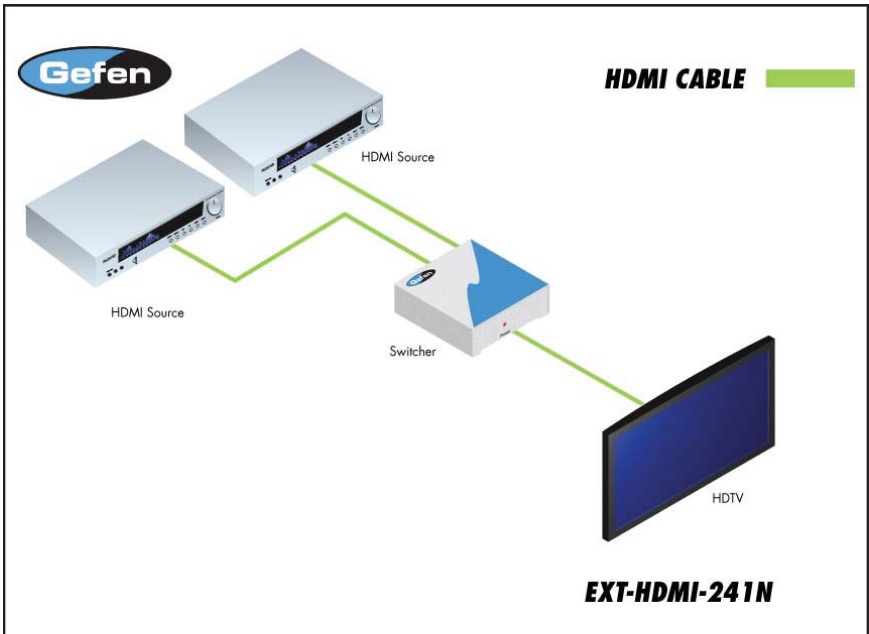

RMT2-IR INSTALLATION

1. Remove battery cover from the back of the RMT2-IR remote.
2. Verify that dip switches 1 & 2 are in the down (OFF) position.
3. Insert the battery, hold the battery so that you can see the positive side facing up. The side that is not marked must be facing down.
4. Test the RMT2-IR remote by pressing ONLY one button at a time. The indicator light on the remote will flash once each time you press a button. **WARNING:** Do not press multiple buttons simultaneously and do NOT press buttons rapidly. These actions will cause the remote to reset and steps 1-4 will have to be repeated.

Note: The RMT2-IR* ships with two batteries. One battery is required for operation, the second battery is complimentary.



The optional IR extender allows you to relocate your HDMI Switcher and still have IR control of the HDMI Switcher. This product is Gefen SKU# EXT-RMT-EXTIR.

* The color of the product shown here may differ from the one you receive.

IR CODE CONFLICTS

How to Resolve IR Code Conflicts

There are matching pairs of dip switches underneath the Switcher unit (outlined below) and under the remote battery cover. Each has two switches which need to be matched for the remote to work. There are 4 possible sets of IR codes and at least one of these sets should be able to resolve any IR conflicts with other home theater devices.

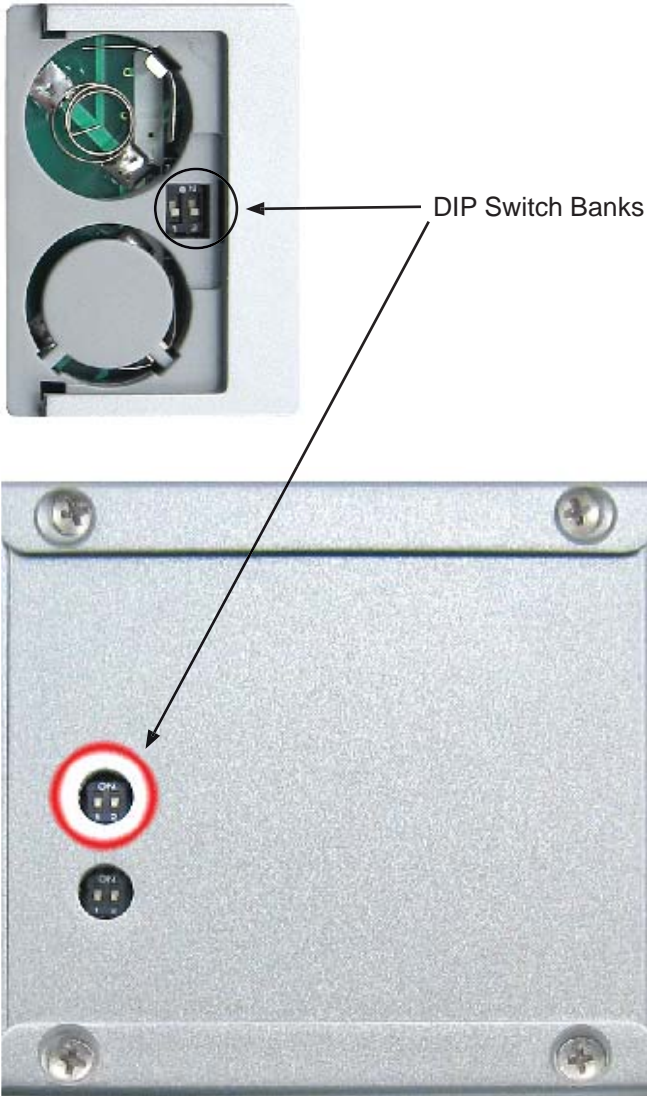

IR EXTENDER INSTALLATION

How to Connect the IR Extender

- 1 Plug the IR extender into the Remote port on the front of the Switcher Unit
- 2 Flip the Dip Switch #1 underneath the unit from the set that is not outlined on the previous page to the ON position

IR CODES

In the event of IR conflicts, please do the following:

1. Remove the battery cover from the back of the RMT4-IR remote.
2. Locate the Dip Switches above the batteries.
3. Switch the Dip Switches on the RMT4-IR to any of the combinations pictured below.
4. Dip Switches 1 and 2 in the RMT4-IR correspond with Dip Switches 3 and 4 on the bottom of the 4x1 DVI Switch respectively. Switch the switches on the bottom of the 4x1 DVI Switch to match the dip switches on the RMT4-IR. The 4x1 DVI Switcher is now set to a new IR Code.

Remote Channel 0:



Remote Channel 1:



Remote Channel 2:



Remote Channel 3:



SPECIFICATIONS

Video Amplifier Bandwidth	165 MHz
Input Video Signal	1.2 volts p-p
Input DDC Signal	5 volts p-p (TTL)
Single Link Resolution	1920 x 1200
HDMI Input/Output Connector Type	Type A (19 pin) female
Power Consumption	15 Watts (max.)
Power Supply	5V DC
Dimensions	4"D x 1"W x 4"H
Shipping Weight	4 lbs.

WARRANTY

Gefen warrants the equipment it manufactures to be free from defects in material and workmanship.

If equipment fails because of such defects and Gefen is notified within two (2) years from the date of shipment, Gefen will, at its option, repair or replace the equipment, provided that the equipment has not been subjected to mechanical, electrical, or other abuse or modifications. Equipment that fails under conditions other than those covered will be repaired at the current price of parts and labor in effect at the time of repair. Such repairs are warranted for ninety (90) days from the day of reshipment to the Buyer.

This warranty is in lieu of all other warranties expressed or implied, including without limitation, any implied warranty or merchantability or fitness for any particular purpose, all of which are expressly disclaimed.

1. Proof of sale may be required in order to claim warranty.
2. Customers outside the US are responsible for shipping charges to and from Gefen.
3. Copper cables are limited to a 30 day warranty and cables must be in their original condition.

The information in this manual has been carefully checked and is believed to be accurate. However, Gefen assumes no responsibility for any inaccuracies that may be contained in this manual. In no event will Gefen be liable for direct, indirect, special, incidental, or consequential damages resulting from any defect or omission in this manual, even if advised of the possibility of such damages. The technical information contained herein regarding the features and specifications is subject to change without notice.

For the latest warranty coverage information, please visit Gefen's Warranty web page at <http://www.gefen.com/kvm/aboutus/warranty.jsp>

PRODUCT REGISTRATION

Please register your product online by visiting Gefen's web site at <http://www.gefen.com/kvm/Registry/Registration.jsp>



Rev X1

20600 Nordhoff St, Chatsworth CA 91311

1-800-545-6900 818-772-9100 fax: 818-772-9120

www.gefen.com

support@gefen.com

